

# CRESTIAL™

Wasser Musik



SERIES **EINS+**





### The CRESTIAL Philosophy

Backed by more than 30 years of participation in the faucet industry, the founding team of S U M International Pte Ltd who owns the CRESTIAL trademark has profound appreciation of customer product expectations. Among the predominant ones are style, value, performance. Accordingly, CRESTIAL faucets are designed with “form follows function” in mind for optimal user-friendliness and minimal fuss.

Durability and reliability are the over-riding design and development criteria of CRESTIAL. That shows our passion for precision and quality. Which is why we use high value materials eg dezincification resistant brass in our concealed mixers. We interpret a minimalist product design concept as: a minimum of material to achieve a maximum of finesse. And what is the net result of this product philosophy? Craftsmanship and simplicity, practicality and beauty are all combined to form a highly personal style.

The heart of the system lies in the premium “made in EU” brands Kerox/Flühs ceramic cartridges and headparts. Tested for 500,000 cycles, these 35mm and 40mm diameter ceramic cartridges and 1/2” brass body ceramic headparts meet or exceed the most demanding test and certification requirements worldwide, complying with relevant performance standards of ACS, DIN, KIWA, EN, ASME, ASSE, CSA and water-contact parts conform with DVGW, WRC, NSF, TUV-SUD-PSB... Likewise stainless steel braided, TUV approved flexible hoses from Tucal and diverters from Neoperl enjoy a European brand heritage. The latter with a 123,000 test cycle track record; on a reality scale a life span of 50 years.

Other design features are equally tangible: ergonomic handles that feel good to hold. Sophisticated, installer friendly mounting systems. Constant flow regulators, read specification options to save water and, at the same time to save energy by virtue of reduced hot water consumption.

The Company, the people echo an amalgamation of skills, competency, expertise... The products, their concise lines, flawless simplicity, precision and durability are other main ingredients to CRESTIAL's all-out distinction. The 5-year no small print warranty for mixers simply proves the point.



Peter Klaus Hoffmann  
Founder/CEO



Singapore WELS  
certified



Australia WELS  
certified



TUV-SUD - PSB  
certified



C33102  
Basin Mixer with Smooth Body

C33103  
Basin Mixer with Pop-up



0035-50  
Mounting Ring



C33102 / C33103 + C18000  
Basin Mixer with Faucet Column  
Overall Height: 303mm



C33201  
Bidet Mixer



C33152  
Basin Mixer with Smooth Body

C33153  
Basin Mixer with Pop-up



C33157  
Basin Mixer  
Overall Height: 315mm



C20400  
3-Hole Wall Mounted Basin Mixer



C33981 + C13085  
Wall Mounted Basin Mixer



C20301  
3-Hole Basin Mixer



C33774  
Basin Mixer



C33650  
Floor Mounted  
Basin Mixer

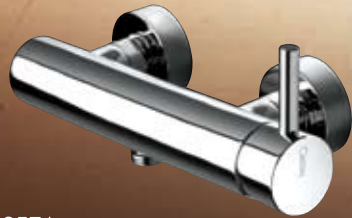

C33571  
Exposed Shower Mixer

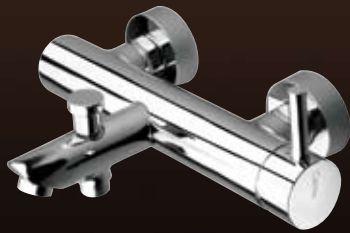

C33574  
Exposed Bath / Shower Mixer



C34100  
Exposed Thermostatic Shower Mixer

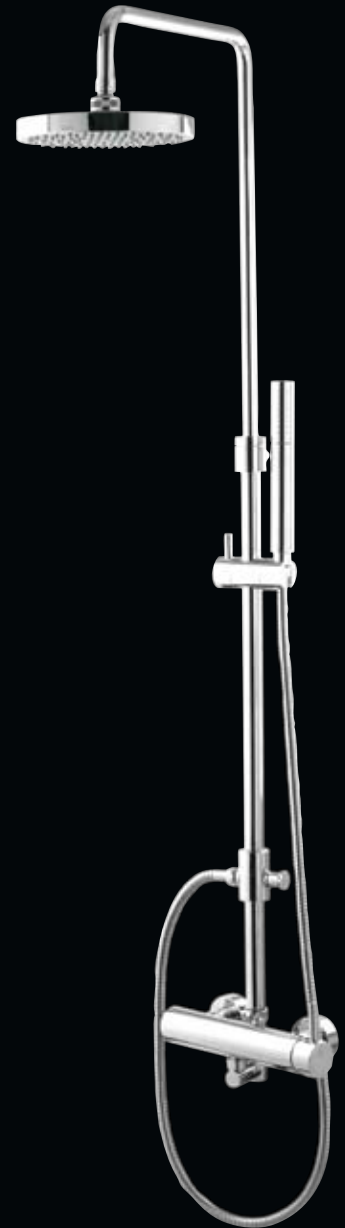

C28015  
Exposed Shower Set with Fixed Holder and  
C28515 Headshower

C28016  
Exposed Shower Set with Adjustable Holder  
and C28515 Headshower

C28066  
Exposed Shower Set with Adjustable Holder  
and C28518 Headshower



C28017  
Exposed Bath / Shower Set with Adjustable  
Holder and C28515 Headshower

C28067  
Exposed Bath / Shower Set with Adjustable  
Holder and C28518 Headshower



C20500  
4-Hole Bath / Shower Mixer  
with C28100 Handshower

C20501  
4-Hole Bath / Shower Mixer  
with C28104 Handshower



C33601  
Floor Mounted Bath /  
Shower Mixer



C29006  
Manual Diverter

C33981  
Concealed Mixer  
ø80mm Cover Plate



C33984  
Concealed Mixer  
ø120mm Cover Plate



C33988  
Concealed Mixer  
ø110mm Cover Plate



C33994  
Concealed Mixer  
ø150mm Cover Plate



C33983  
Concealed Bath / Shower Mixer  
ø150mm Cover Plate



C33986  
Concealed Mixer  
90x90mm Cover Plate



C33987  
Concealed Bath / Shower Mixer  
113x172mm Cover Plate



C33989  
Concealed Bath / Shower Mixer  
123x183mm Cover Plate





C33776  
Sink Mixer



C33777  
Sink Mixer



C33778  
Sink Mixer



C33791  
Sink Mixer with  
Extendible Spray



C33795  
Sink Mixer with  
Pull-out Spray

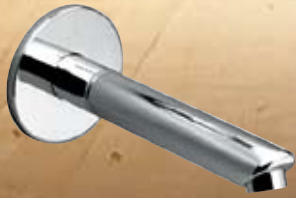

C13085  
Basin Spout  
Projection: 175mm

C13100  
Bath Spout  
Projection: 168mm



C20101  
Pillar Tap

C20103  
Bib Tap



C20107  
Pillar Tap

C20201  
Concealed Valve (H)



C20202  
Concealed Valve (C)



C22100  
Shower Valve

C22003  
Angle Valve



C23002  
Bottle Trap



C23005  
Bottle Trap





S T Y L E • P E R F O R M A N C E • V A L U E

CRESTIAL Germany  
Crestial S U M International Pte Ltd  
58682 Menden

CRESTIAL Singapore

S U M International Pte Ltd

Tel (65) 6333 5323  
Fax (65) 6333 5336  
Email [sumintl@pacific.net.sg](mailto:sumintl@pacific.net.sg)  
Website [www.crestial.com](http://www.crestial.com)